

Question: How to choose the correct brush size?

Answer:

There are two choices depending on your preference:

Use a smaller Brush

For the customer that prefers a less expensive tool that requires multiple passes.

TOOL COST CONCERN

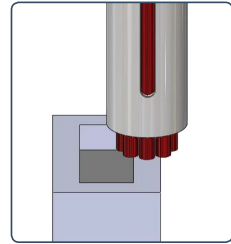
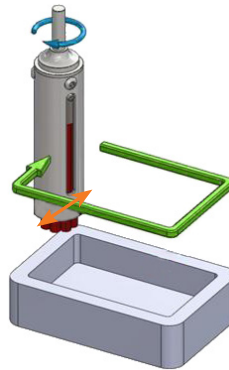

Use a larger brush

For the customer that is most concerned about minimizing cycle time.

CYCLE TIME CONCERN

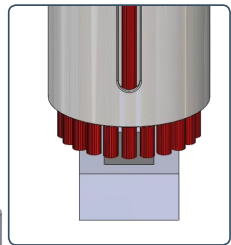
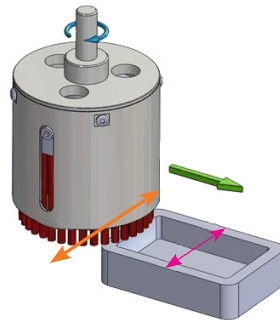

Work Piece

Brush Size



= 1 : 1.5 - 2 Ratio

Choose a brush size which is 1.5 to 2 times wider than the width of the surface of the workpiece. This allows the brush to engage the workpiece edge by 90° for optimal grinding power.